

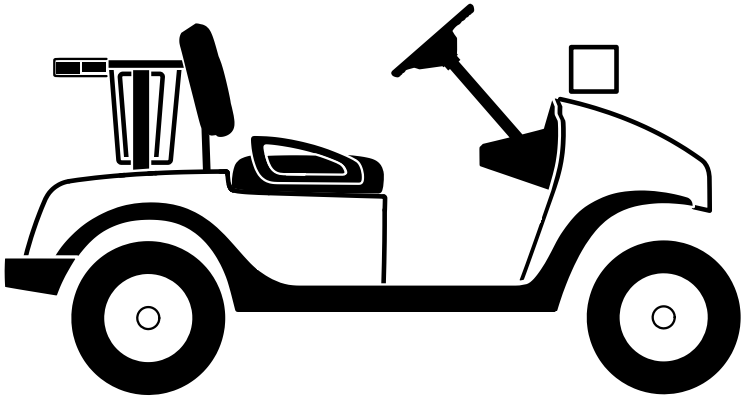

CLARK[®]



Operator's Manual

GC2, TR246, GO240

OM-726
September 2013

**Do not remove this manual
from the truck.**

Record the following information pertaining to your vehicle.

Model No. _____

Serial No. _____

Customer Vehicle Identification No. _____

Vehicle Weight, Empty _____

Vehicle Rated Capacity _____

Vehicle Gross Weight _____

Special Equipment or Attachments _____

IMPORTANT

Do not expose this manual to hot water or steam.

Foreword

Foreword	ii
Summary of Safe Operating Procedures	v
1. General Safety Rules	1.1
2. Know your Golf Car	2.1
3. Daily Inspection	3.1
4. Operator Maintenance and Care	4.1
5. Planned Maintenance and Lubrication	5.1
6. Specifications	6.1

Foreword

Before you start operating this golf car, make sure that you understand all driving procedures. It is important to operate your vehicle safely and efficiently.

This manual will help you learn how to operate your golf car. This manual describes the controls, special features and the functions of each control.

This manual is not a training manual, it is a guide to help authorized operators safely operate a golf car. Illustrations in this manual show the operator correct procedures for checking, starting, operating and stopping the golf car.

CLARK golf cars are built to take hard work, but not abuse. They are built to be dependable but as with any golf car, they are only as efficient as the operator and the persons responsible for maintaining them.

Do not make any repairs to this golf car unless you have been trained in repair procedures and authorized by your employer.

This Operator's Manual should help you to make the best use of your CLARK golf car. Read through the instructions carefully and follow the given procedures strictly. Acquaint yourself with the controls and in particular observe all the safety regulations. Carry out all maintenance and care work at the recommended time intervals. CLARK golf cars are characterized by their easy maintenance design. You will therefore be able to carry out this work in a short time and without too much effort.

Regular maintenance and care of your golf car is recommended not just on economic grounds, but because a faulty golf car represents a source of potential danger.

In addition you should observe all Federal, State, Provincial and Local regulations which provide inspections at set intervals of time.

For any checkup, repair, maintenance and all other work concerning your golf car please contact your CLARK dealer. Here, specially trained service personnel will be glad to help you at any time. Should you desire to carry out maintenance, repair and all other work on your golf car yourself, you can of course obtain all required spare parts and all necessary materials from your CLARK dealer.

Foreword

Please note: To help assure trouble free functioning and optimum economy of your CLARK golf car, be sure to use only original CLARK spare parts.

Original CLARK spare parts are the best for your golf car. With their dimensional stability as well as their high material quality due to continuous and strict quality control, they correspond to those parts used in the series production of our golf car.

Finally we would like to draw your attention to the fact that any secondary damages due to improper handling, insufficient maintenance, wrong repairs or the use of other than original CLARK spare parts waive any liability by CLARK and voids the warranty.

Foreword

YOU can prevent accidents

- First: Learn safe operating rules.
- Next: Read your Operator's Manual. If you do not understand it, ask your supervisor for help.
- Learn about the unit you operate.

KNOW YOUR GOLF CAR

- Then: Practice operating your golf car safely.
- And: Keep your golf car in safe operating condition with correct and timely maintenance.



Breaking these rules will cause serious or fatal injury to yourself and others.

Foreword

Summary of Safe Operating Procedures

1. Do not operate this golf car until you have checked it's condition. Give special attention to tires, horn, lights, battery, brakes, steering mechanism, and guards.
2. Operate only from designated operating position. Never place any part of your body outside of the confines of the vehicle.
3. Do not overload the golf car.
4. Start, stop, travel, steer and brake smoothly. Slow down for turns and on uneven or slippery surfaces that could cause the golf car to slide or over-turn.
5. When making a turn, allow for "corner-cutting" on longer wheel base models.
6. When moving in reverse, get assistance if vision is obstructed.
7. Make sure correct tire pressures are maintained.
8. Do not run over objects on the traveled surface.
9. Use special care when operating on inclines - travel slowly, and do not angle or turn.
10. If a golf car must be parked on an incline, put chocks at the wheels.
11. Observe applicable traffic regulations and YIELD the right-of-way to pedestrians. Slow down and sound horn at cross paths and wherever vision is obstructed.
12. Make a report of all accidents involving personnel, building structures and equipment to the correct authority.
13. Before getting off the vehicle turn the ignition switch OFF. Set the parking brake.

Foreword

Safety Signs and Messages

Improper operation can cause accidents. Don't take chances with incorrect or damaged equipment. **Read** and **understand** the procedures for safe driving and maintenance outlined in this manual. Don't hesitate to ask for help. **Stay alert!** Follow safety rules, regulations, and procedures. Avoid accidents by recognizing dangerous procedures or situations before they occur. **Drive and work safely** and follow the safety signs and their messages on the golf car and in this manual.

Safety signs and messages are placed in this manual and on the golf car to provide instructions and identify specific areas where potential hazards exist and special precautions should be taken. Know and understand the meaning of these instructions, signs, and messages. Damage to the golf car, serious injury or death to you or other persons may result if these messages are not followed. If warning decals are damaged, they must be replaced. Contact your CLARK dealer for replacements.

NOTICE

This message is used when special information, instructions or identification are required relating to procedures, equipment, tools, pressures, capacities and other special data.

IMPORTANT

This message is used when special precautions should be taken to ensure a correct action or to avoid damage to or malfunction of the vehicle or a component.

CAUTION

Indicates a potentially hazardous situation which, if not avoided, may result in minor or moderate injury. It may also be used to alert against unsafe practices.

WARNING

Indicates a potentially hazardous situation which, if not avoided, could result in death or serious injury.

DANGER

Indicates an imminently hazardous situation which, if not avoided, will result in death or injury.

General Safety Rules

Contents

Contents	1-1
The Golf Car	1-2
Inspection	1-3
Operation	1-3
When Driving	1-4
Climate condition for Operation	1-6
Operator Responsibilities	1-9
Traveling	1-8
Loading	1-9
Parking	1-9
Passengers	1-9
Pedestrains	1-9
Operator Protection	1-10
Golf Car Tip-Over	1-10
Additional Regulations for Special Tasks	1-11
Golf Car used for Transporting People	1-11
Parking the Golf Car	1-11
Fire Extinguisher	1-12
Charging Batteries of Electric Vehicles	1-12
General Tire Maintenance, Inspection and Repair	1-13
Repairs	1-13

General Safety Rules

The Golf Car

Use in accordance with the regulations.

Golf cars may only be used in accordance with these operating instructions.

- Golf cars are designed to transport people, light loads, small or large loads depending on the model.
- If a golf car is to be used for other purposes, permission must be obtained from CLARK, in writing, and if necessary from the supervisory authorities responsible, in order to prevent hazards from arising.

Stability

- CLARK golf cars are stable in both working positions and when being driven, so long as you operate and use properly and always observe (and never exceed) the maximum permissible load.

Inspection

Inspection prior to initial use

- The golf car must be checked for proper functionality prior to operation. The working area to be used must be inspected for its ground conditions.
- Golf cars must be regularly checked by trained and authorized service personnel. CLARK recommends an annual check-up based on an average operational performance.

General Safety Rules

Operation

The driver

- Observe all State, Federal and Provincial laws and regulations.
- Carefully read and understand the contents of this Operator's Manual.
- Never operate your golf car with wet or oily hands or shoes. If you slip off the brake pedal or the steering wheel, serious accidents and personal injury may occur.

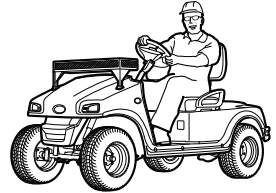

The working area

- Never drive in areas which are closed to golf cars, only use areas cleared for golf car operation. Traveling and loading areas must be clearly identified and free of obstacles.
- Golf cars shall only be used on routes without sharp curves, excessive slopes and grades which are too narrow or too low. Watch the road surface - it must be sufficiently smooth and free of bumps. Observe all State, Federal and Provincial laws and regulations.

General Safety Rules

Getting ON/OFF the Golf Car

- It is very dangerous to jump on or off the equipment.
- To get on or off the equipment, stop the equipment.
- The general rule is that the operator shall always dismount when facing the vehicle.
- Never park your golf car on grades. But if this is necessary always secure the vehicle with chocks.

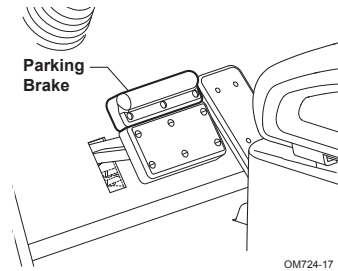

When Driving

Driving conduct

- The operator shall comply with traffic regulations and the relevant road traffic regulations on public roads if your golf car is rated for on-the-road use. The speed of the golf car has to be adjusted to local conditions.

For example: (sound horn when encountering)

- the operator shall drive slowly in bends.
- and in narrow passageways or grades.
- when driving through swinging doors.
- at blind intersections or on uneven surfaces.

The operator shall keep a safe braking distance from vehicles or persons in front of him and must always have his vehicle under control. Sudden stops, quick turns, overtaking at dangerous or blind intersections shall be avoided.

Golf cars must not be put in motion when the operator is not in the operator's seat.

While driving it is forbidden:

- to put arms or legs outside the vehicle.
- for the operator to lean over the edge of the golf car.
- to move from one vehicle to another or to fixed parts of a building.

The operator shall bring his vehicle to a complete stop as soon as possible if steering becomes defective.

General Safety Rules

Braking

The driving speed must be selected so that there is always an adequate braking distance in front of the vehicle. It should be noted in this respect that the pure braking distance increases at a higher rate of speed and that the drive wheels may spin or the vehicle may overturn in case of sudden braking.

Grades

- Always reduce your speed and drive with special care on grades.
- Always keep the load fixed if you drive on grades.
- With restricted visibility always seek assistance when traveling on grades.
- Do not turn when going up or down a grade. Never drive diagonally across the grade. The vehicle can easily roll over in this case.
- Grades should always have a sufficiently rough surface for good traction. Grades used by vehicles shall not exceed the limits specified by the manufacturer (see specifications).



CAUTION

Avoid slippery or loose conditions

Slippery Surfaces

Extreme caution should be used when driving on slippery terrain. Wet grassy areas or ice for example may cause a golf car to lose traction and may adversely affect operator control.

Loose Terrain

Extreme caution shall be used when driving in areas of loose terrain. Loose terrain such as sand or gravel can cause a golf car to lose traction and may affect steering, braking and stability.

General Safety Rules

Climatic condition for Operation

- Maximum ambient temperature, short term (up to 1h): +104°F (+ 40°C).
- Average ambient temperature for continuous duty: +77°F (+ 25°C).
- Lowest ambient temperature: -4°F (- 25°C) (in normal outdoor condition), +41°F (+ 5°C) (in normal indoor condition).
- Service altitude: up to 6560 ft (2000m) above sea level.
- Relative humidity: in the range 30% to 95% (non-condensing)

Tips for Operation according to the Weather:

1) Hot Weather

- Driving in hot weather impairs driving ability and work efficiency. Take rest at regular intervals.

2) Cold Weather

- Remove the ice, snow or frost on the weather enclosure window before start operation. (If weather enclosure installed)
- Take utmost care when driving on icy surface.
- Do not step on slippery surface when getting in or out of the equipment.
- Use an ice removing device equipped with a handle and ladder to remove ice, snow or frost.
- Replace worn tires immediately. Especially, worn tires can cause serious accident on icy ground.
- Do not apply abrupt braking or starting on icy ground.



Do not expose bare skin to the cold, metal surface of the equipment.

General Safety Rules

Operator's Responsibilities

Read and understand operators' manual

- **Do not** operate golf car under the influence of drugs and alcohol.
- Watch for pedestrians at all times. **Do not** drive the golf car in a manner that could cause danger to others.
- Only operate golf car while seated in the operators position.
- Riding on the golf car by persons other than the operator is authorized only on personnel seat(s) provided by the manufacturer. **Keep all your body parts within the confines of the golf car.**
- When a golf car is to be left unattended, bring the golf car to a complete stop, apply the parking brake. Turn the key switch to the off position and remove the key.
- Chock the wheels if the golf car is on an incline.
- Always park a safe distance from potential hazards, such as edges of ramps and platforms.
- Only use approved golf cars in locations as defined by the appropriate safety standards.
- Report all accidents.

General Safety Rules

Traveling

- Observe all traffic regulations, including posted speed limits. Under normal traffic conditions keep to the right. Maintain a safe distance, based on speed of travel from a vehicle in front of you. Keep the golf car under control at all times.
- Yield the right of way to pedestrians, ambulances, fire trucks, or other golf cars or vehicles in emergency situations.



OM724-20

- Do not pass another golf car or vehicle traveling in the same direction at intersections, blind spots, or at other dangerous locations.
- Keep a clear view of the path of travel, observe other traffic and personnel, and maintain a safe clearance.
- Slow down or stop, as conditions dictate, sound horn or warning device at cross aisles and when visibility is obstructed at other locations.
- Travel up and down grades slowly.
- Avoid turning, if possible, and use caution on grades, ramps, or inclines, normally travel straight up and down.
- Under all travel conditions the golf car shall be operated at a speed that will allow it to be brought to a stop in a safe manner.
- Make starts, stops, turns, or direction reversals in a smooth manner so as not to shift the load, endanger passengers, or lose control of the golf car.
- Do not operate golf car in a dangerous manner.
- Slow down when approaching, or on, wet or slippery surfaces.
- Do not drive golf car onto any elevator unless specifically authorized to do so. Approach elevators slowly, and then enter squarely after the elevator car is properly leveled. Once on the elevator, place direction control in neutral, turn key switch to the off position and set parking brake.
- Avoid running over loose objects, potholes, and bumps.
- Slow down golf car when turning.

General Safety Rules

Parking

- Never park on a grade.
- Always come to a complete stop before leaving golf car.
- Set parking brake.
- Turn key to OFF position.

Passengers

Only carry passengers when there is adequate seating provided. Never allow passenger on a golf car without available seating.

Pedestrains

Watch where you are going. Look in the direction of travel. Pedestrians may use the same roadway you do. Sound your horn at all intersections or blind spots. Watch for people in your area even if your car has warning lights or alarms. People may not watch for you.

Operator Protection

Always keep your body within the confines of the golf car.

Keep your body within the confines of the optional canopy if installed.

IMPORTANT

Optional canopy does not protect against falling objects and is not designed to provide rollover protection.

General Safety Rules

Golf Car Tip Over

Golf cars can be tipped over if not operated properly. Teach your operators that there are a number of things they must watch for that can cause a vehicle to tip over.

- Slow down before turning. Go into and out of turns slowly, using a slow rotation of the steering wheel.
- Do not turn on down - and up - slopes
- Drive careful and slowly at ramp edges or steps
- You may operate the vehicle empty, close to its top speed. Slow down before turning.

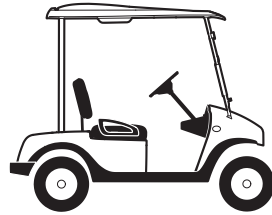

OM724-10

The operator and passengers must follow the instructions to prevent serious personal injury if the equipment overturns.

- Hold the steering wheel firmly. Stiffen your legs to support yourself.
- Lean against the opposite side wall, as shown in the figure.



Lean away



General Safety Rules

Additional Regulations for Special Tasks

Golf Cars used for Transporting People

- The transport of persons by the golf car is only allowed if the vehicle is designed for the transporting people and if the appropriate seating is available. Otherwise the transport of persons is prohibited.

Parking the Golf Car

- Park your golf car in authorized areas only.
 - apply the parking brake
 - turn the key to “OFF” position
 - remove the key.

General Safety Rules

Charging Batteries of Electric Vehicles

- The maintenance of batteries may only be carried out in areas particularly designed for this purpose by qualified personnel.
- Please carefully read the operating instructions of the charger manufacturer.

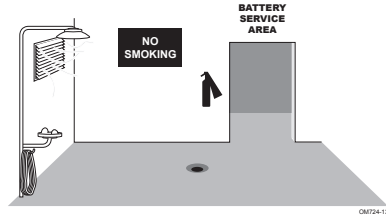

WARNING

Smoking and handling of open fires in charging stations is prohibited.



Fire Extinguisher

- Prepare a fire extinguisher at the designated place and learn how to use it to prepare for a fire accident.
- You must be well aware of the actions to take in a fire or other accident.
- Define the emergency contact and prepare communication means and contact information.



Waste Disposal

- Do not dump waste oil in sewer or river.
- Collect drain oil in an oil pan.
- Never spill waste oil on the ground.
- The waste materials from oil or battery must be classified and kept at designated places and disposed of by an authorized disposal service provider or nearest A/S center.

General Safety Rules

General Tire Maintenance, Inspection and Repair

- Check for correct tire inflation air pressure. See specifications for correct tire pressure for your truck.
- Check tire pressure from a position facing the tread of the tire, not the side. Use a long-handled gauge to keep your body away from the side.
- If tires are low, have tires and wheels inspected by a person trained and authorized to do tire and wheel maintenance. The tires may require removal and repair.
- Incorrect (low) tire pressure can reduce the stability of a golf car and cause it to tip over.

IMPORTANT

Check wheels and tires for damage every time you check tire pressure. Make repairs when needed. Dirt can get into cuts and cause damage to the tire cord and tread. Remove debris from all cuts.

Repairs

- Safety equipment and switches may not be removed or made inefficient. Factory set adjustment values may not be changed.
- For any checkup, repair, maintenance and all other work concerning your golf car, please contact your CLARK dealer. Here, specially trained service personnel will be glad to help you at any time.
- Should you desire to carry out maintenance, repair and all other work on your golf car yourself, you can of course obtain all required spare parts and all necessary materials from your CLARK dealer.
- Please note: To help assure trouble free functioning and optimum economy of your CLARK golf car, be sure to use only original CLARK spare parts.
- Original CLARK spare parts are the best for your golf car. With their dimensional stability as well as their high material quality due to a continuous and strict quality control, they correspond to those parts used in the series production of our golf cars.

General Safety Rules

Know Your Golf Car

Contents

Contents	2-1
Model Designation	2-2
Nameplate and Decal Location	2-3
Nameplate and Decals	2-4
Operator Compartment	2-6
Golf Car Arrangements	2-9

Know Your Golf Car

Model Designation

GC2 (Golf Car)

Is designed for light hauling and carrying the operator and one passenger.

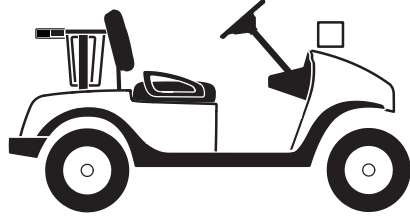

GO240 (Goat)

Is designed for light hauling and carrying the operator and up to three passengers depending on model over rough terrain.

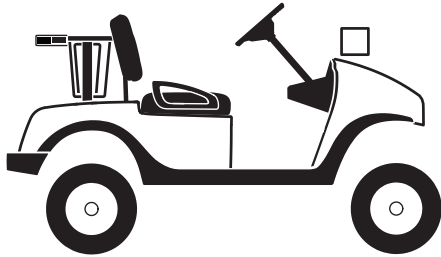

TR240 (Transport)

Is designed for carrying the operator and multiple passengers.



Each model has a number of configurations depending on application. See your CLARK dealer for a list of options.

Know Your Golf Car

Nameplates and Decal Location

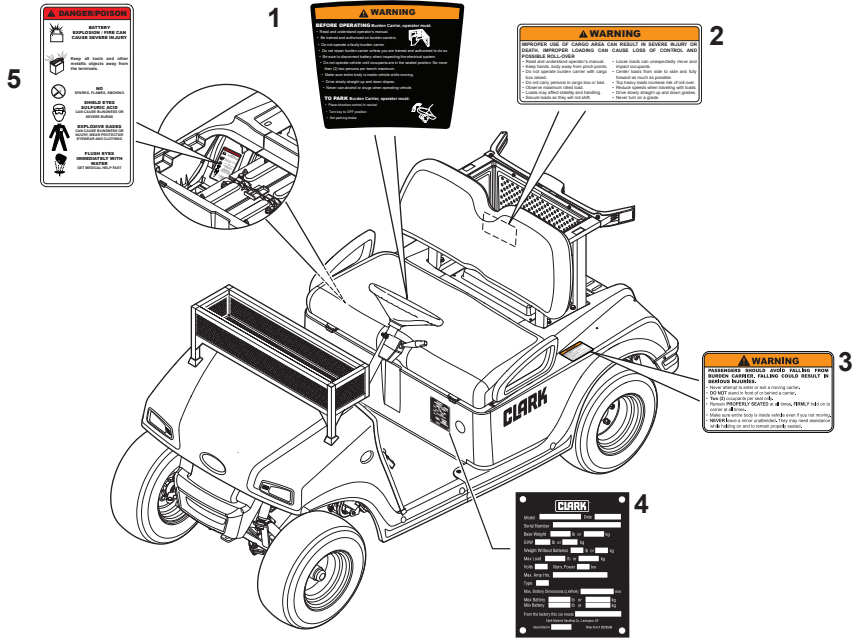

- 1 Operator Warning Decal
- 2 Cargo Area Warning Decal
- 3 Passenger Warning Decal
- 4 Data Plate
- 5 Battery Warning Decal

Know Your Golf Car

Nameplates and Decals

Operator Warning Decal

This decal outlines the requirements for safe operation of a golf car.



Passenger Warning Decal

This decal outlines the requirements for passenger safety of golf car.



Know Your Golf Car

Data Plate

The data plate is designed to inform personnel of the golf car's capacity and other important vehicle information.

The operator should read and understand the data plate before using the vehicle.

CLARK

Model Date

Serial Number

Base Weight lb or kg

GVW lb or kg

Weight Without Batteries lb or kg

Max Load lb or kg

Volts Nom. Power kw

Max. Amp Hrs.

Type

Max. Battery Dimensions (LxWxH) mm

Max Battery lb or kg

Min Battery lb or kg

From the factory this car meets

Clark Material Handling Co., Lexington, KY

Assembled in

Battery Danger Decal

This decal outlines the requirements for safe handling of batteries when charging or working in or around battery compartment.

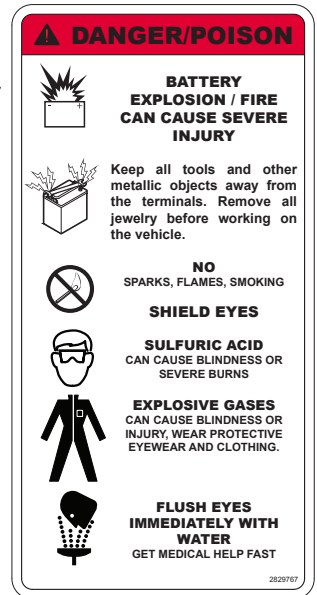

Know Your Golf Car

Operator's Compartment

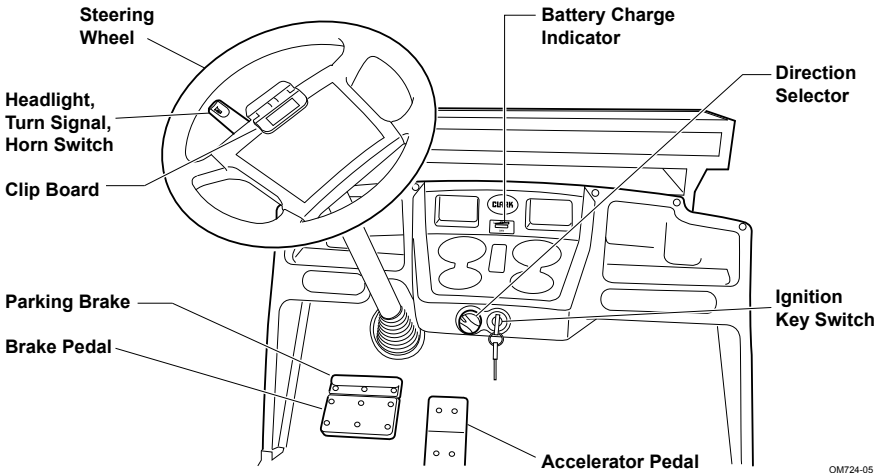

OM724-05

Ignition Key Switch

- When not in use, the key should remain in the **OFF** position with the parking brake latched.
- To activate the flow of power to the motor, the key should be turned to the **ON** position.
- The ignition key switch has a 3rd position **ACC** that activates the 12 volt system, lights, horn, and any other accessories wired to the DC/DC power converter.

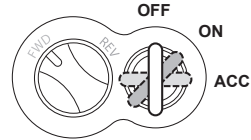

OM724-02

Direction Selector

Use the FORWARD/REVERSE switch to select the desired direction of travel.

- If you want to travel forward, turn the switch to the **FWD** (left side).
- If you want to travel in reverse, turn the switch to the **REV** (right side).

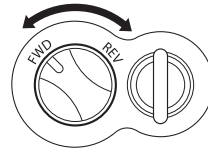

OM724-03

Know Your Golf Car

Accelerator Pedal

This will control your speed. Press down slowly to increase speed. The vehicle will speed up with continued pressure applied to the pedal, eventually reaching full speed. The vehicle will slow down as you take pressure off the pedal. When the pedal is fully lifted the electronic brake feature will begin to function.

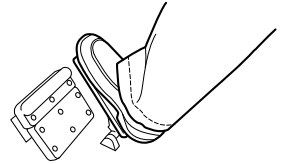

OM724-04

Brake Pedal

Is used in deceleration or parking. By depressing the brake pedal slowly the golf car should come gentle stop. Avoid hard braking, allow yourself plenty of stopping distance.

- The travel distance of the brake pedal should be $\frac{2}{3}$ of the distance from the pedal resting on the floor.

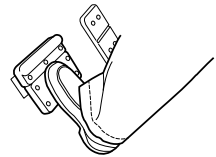

OM724-06

IMPORTANT

If the vehicle accelerates too quickly or the electronic brake function is not working properly, stop the vehicle immediately. Contact your Clark authorized dealer or trained mechanic immediately.

Parking Brake

Is used when the golf car is unattended or stopped on an incline.

- If the parking brake fails to remain in the down position, the parking brake is **NOT** set.
- Repeat the procedure again until the parking brake latches firmly into place.
-

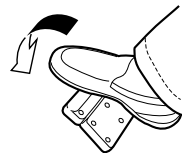

OM724-07

WARNING

If you accidentally set the parking brake while descending a slope, you should release the parking brake by depressing the service brake pedal. DO NOT release the parking brake by depressing the accelerator pedal in this situation as to prevent personal injury and vehicle damage.

Know Your Golf Car

Battery Charge Indicator

The indicator is divided into 10% increments. The indicator will fall from the higher percentage (100% charge) to the lower percentage as the batteries discharge.

- When the battery is too low, the red indicator light will flash reminding you to recharge the battery. Allowing the battery to discharge below 20% could cause permanent damage to the batteries.
- It is best practice to charge the batteries after every use. See Battery Charging for complete instructions on how to recharge the electric batteries.

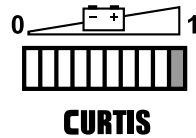

OM724-08

Lights, Horn and Turn Signals

Located on the steering column just below the steering wheel. It becomes active when the key switch is turned to the 3rd position.

- Twisting the barrel switch forward illuminates the front and rear lights. Movement up and down activates the turn signals, and depressing the button at the end of the lever sounds the horn.

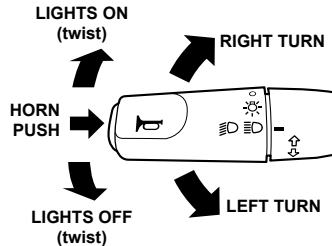

OM724-09

Know Your Golf Car

Operating Procedures

- Turn the ignition switch to either **ON** or **ACC** position.
- Select direction of travel, either **FWD** (forward) or **REV** (reverse).
- Gradually press down on the accelerator pedal to increase speed.
- Use turn indicators where necessary.
- When arrived at destination, engage parking break, roll the headlight switch to the **OFF** Position, and turn the ignition switch to the **OFF** position.

WARNING

If you press down on the accelerator pedal before switching the ignition key to the **ON** position, the vehicle will **NOT** move. If this happens, release the accelerator pedal, then return the ignition to the **OFF** position and re-do the procedure. The vehicle should begin to operate properly.

Golf Car Arrangement

Rear Seating with Hand Rails (if equipped)

Golf cars with rear seating are equipped with handrails for passengers safety.

- Passengers must firmly hold onto handrails anytime vehicle is in motion.

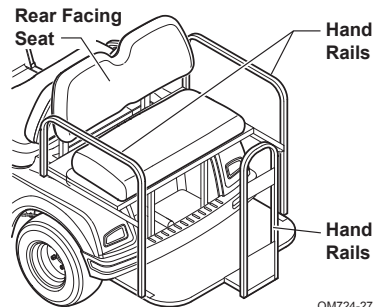

Know Your Golf Car

Daily Inspection

Contents

Inspecting Your Golf Car	3-2
Visual Checks	3-3
Functional Checks	3-3
Concluding the Inspection	3-4

Daily Inspection

Inspecting Your Golf car

Before using a golf car, check its condition and be sure it is safe to operate.

Check for damage and maintenance problems; have repairs made before you operate the golf car. Unusual noises or problems must be reported immediately to a designated authority.

Do not make repairs yourself unless you are trained in golf car repair procedures and authorized by your employer. Have a qualified mechanic make repairs using genuine CLARK or CLARK-approved parts.

CAUTION

Do not operate a golf car if it is in need of repair. If it is in an unsafe condition, remove the key and report the condition to the proper authority. If the golf car becomes unsafe in any way while you are operating it, stop operating the vehicle, report the problem immediately, and have it corrected.

Visual Checks

First, perform a visual inspection of the golf cars major components:

Walk around your golf car and take note of obvious damage that may have been caused during previous usage.

Check that all capacity, safety, and warning plates or decals are attached and legible.

Check that the batteries are installed and secured in position correctly. Check battery connectors for safe condition.

Look for any external leakage.

Be sure that the safety devices are in place, undamaged, and attached securely.

Check all of the critical components that handle or carry the load.

Check for obvious wear and maintenance problems such as damaged or missing parts, leaks, bent parts, and so on.

Inspect the wheels and tires for safe mounting and wear condition.

Daily Inspection

Functional Checks

Check the operation of the golf car as follows:

NOTICE

Before performing these checks, familiarize yourself with the operating procedures.

1. With key switch off, be sure all controls and systems operate freely and return to neutral properly. Check the:
 - Service and parking brake
 - Accelerator control
 - Directional control
 - Steering system
 2. Test warning devices, horn, lights, and other safety equipment and accessories.
 3. With the golf car on, check the battery charge display. The display should show the charge remaining on the batteries.
 4. When the functional checks are completed:
 - Bring vehicle to complete stop.
 - Apply the parking brake.
 - Turn the key switch to the OFF position.
- If you are going to leave the golf car unattended:
- Remove the key.
 - Block the wheels if the vehicle has any possibility of moving.

Daily Inspection

Concluding the Inspection

Make a record of all the operating and vehicles problems that you find. Review the list to be sure it has been completed and turn it in to the person responsible for maintenance. Be sure any unusual noises or problems are investigated immediately.

NOTICE

Do not operate a golf car that has a maintenance problem, or is not safe to operate.

IMPORTANT

If all checks were normal or satisfactory, the golf car can be operated.

Operator Maintenance and Care

Contents

Maintenance Practices	4-2
Functional Checks	4-4
Battery Maintenance	4-4
Cleaning the Vehicle	4-6

Operator Maintenance and Care

MAINTENANCE PRACTICES

CAUTION

Golf cars may become hazardous if maintenance is neglected.

- Maintenance and inspection of golf cars shall be performed in conformance with the following practices and should follow CLARK'S recommendations.
- Follow planned maintenance schedule.
- Only trained and authorized personnel shall be permitted to maintain, repair, adjust, and inspect golf car.
- Before undertaking maintenance or repair follow CLARK'S recommendations for disabling a golf car.
- Chock wheels and support golf car, before working underneath it.
- Operation to check performance of the golf car shall be conducted in an authorized area where suitable conditions exist, free of vehicular and pedestrian traffic.
- Avoid fire hazards and have fire protection equipment present in the work area. Do not use an open flame to check level or leakage of fuel, battery electrolyte.
- Properly ventilate the work area in accordance with applicable regulations or local ordinance.
- Brakes, steering mechanisms, speed and directional control mechanisms, warning devices, lights, guards, and safety devices shall be inspected regularly and maintained in accordance with CLARK'S recommendations.
- Special devices designed and approved for hazardous area operation shall be inspected to ensure that maintenance preserves the original approved safe operating features.
- Decals and plates must be legible and maintained as necessary.

Operator Maintenance and Care

- Batteries, motors, speed and directional controllers, protective devices, electrical devices must be inspected and maintained in good working order to minimize hazards and facilitate detection of components needing service.
- Modifications and additions which affect capacity and safe golf car operation shall not be performed without CLARK'S prior written authorization; where authorized modifications have been made, the user shall ensure that capacity, operation, warning, and maintenance instruction plates, tags, or safety labels are changed accordingly.
- Care shall be taken to ensure that all replacement parts are interchangeable with the original parts and of a quality at least equal to that provided in the original equipment.
- Disconnect batteries, negative connection(s) first. When reconnecting, connect positive connection first.
- Your golf car is equipped with a ON-BOARD charging system. Make a visual check of the charger, cables and plug.

WARNING

Do not charge batteries if any damage to charger, cables or plugs are visible. Fire and/or explosion could occur. Have a trained and authorized mechanic inspect the charger.

Operator Maintenance and Care

Functional Checks

Check the operation of the golf car as follows:

NOTICE

Before performing these checks, familiarize yourself with the operating procedures.

1. With key switch off, be sure all controls and systems operate freely and return to neutral properly. Check the:
 - Service and parking brake
 - Accelerator control
 - Directional control
 - Steering system
2. Test warning devices, horn, lights, and other safety equipment and accessories.

When the functional checks are completed:

- Bring golf car to complete stop.
- Apply the parking brake.
- Turn the key switch to the OFF position.

If you are going to leave the golf car unattended:

- Remove the key.
- Block the wheels if the golf car has any possibility of moving.

Battery Maintenance

WARNING

To reduce the possibility of electrical shock or possible electrocution, be sure that the on board charger plug is not damaged and is inserted into a proper grounded receptacle.

The power (AC) cord is equipped with a grounded plug, do not attempt to remove, cut or bend the ground post of the grounded plug.

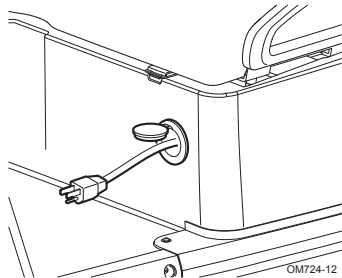

Operator Maintenance and Care

Battery Watering System (if installed)

WARNING

EXPLOSIVE GASES: Do not smoke or have open flames or sparks near batteries. An explosion can cause injury or death.

IMPORTANT

NEVER add distilled water to a low battery. This could shorten the life of the battery. Only add distilled water after a battery is fully charged.

The on-board battery watering system works by replacing each of the battery's existing vent caps with vent cap and valve combinations. Each are interconnected with tubing, allowing the user to fill all cells of the battery from a single location. Each valve independently shuts off water flow to the cell when the proper electrolyte level is reached. This is critical to prevent overwatering cells.

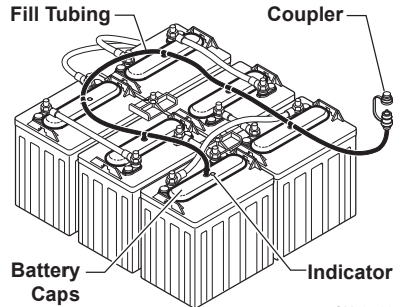

OM724-22

IMPORTANT

Battery watering system caps are a one time use only. Once caps are removed you must replace with new cap.

Each battery cap has an indicator to let you know when your battery is low and is in need of refilling. If the indicator shows "black" the battery is okay. If the indicator shows "white" the battery needs refilling. The caps fill with distilled water and will distribute to each cell.

Operator Maintenance and Care

CLEANING THE VEHICLE

CLARK golf car bodies are hand-washable. Use only mild automotive cleaners with a sponge or soft cloth for normal cleaning. A garden hose at normal residential water pressure is adequate.

CAUTION

CLARK does not recommend any type of pressure washing. Pressure washing could expose electrical components to moisture. Moisture entering electrical components can result in water damage and component failure.

CAUTION

- **Never use abrasive rubbing compounds, this will permanently dull finish of vehicle.**

When cleaning seats use a solution of 10% liquid soap and warm water applied with a soft cloth. A soft bristle brush may be used for imbedded dirt.

NOTE: Dispose of waste water properly.

Planned Maintenance and Lubrication

Contents

Contents	5-1
Planned Maintenance	5-2
PM Reprt Form	5-7
Visual Inspection	5-10
Battery / Charger Compartment	5-13
Battery Inspection	5-13
Charging Plug	5-13
Designated Charging Area.....	5-14
Batteries.....	5-14
Battery Charging.....	5-15
Lubrication	5-17

Planned Maintenance and Lubrication

Planned Maintenance

NOTICE

ONLY TRAINED AND AUTHORIZED PERSONNEL should perform Planned Maintenance. Local CLARK dealers are prepared to help customers put in place a Planned Maintenance program for checking and maintaining their golf car according to applicable safety regulations.

CAUTION

Golf cars may become hazardous if maintenance is neglected.

The operator should make a safety inspection of the golf car before operating it. The purpose of this daily examination is to check for any obvious damage and maintenance problems, and to have minor adjustments and repairs made to correct any unsafe condition.

In addition to the operator's daily inspection, CLARK recommends that the owner set up and follow a periodic planned maintenance (PM) and inspection program. Performed on a regular basis by **trained personnel**, the program provides thorough inspections and checks of the safe operating condition of the golf car. The "PM" identifies needed adjustments, repairs, or replacements so they can be made before failure occurs. The specific schedule (frequency) for the PM inspections depends on the particular application and lift truck usage.

This section recommends typical Planned Maintenance and Lubrication Schedules for items essential to the safety, life, and performance of the vehicle. It also outlines safe maintenance practices and gives brief procedures for inspections, operational checks, cleaning, lubrication, and minor adjustments.

If you have need for more information on the care and repair of your vehicle, see your CLARK dealer.

Planned Maintenance and Lubrication

The following instructions have been prepared from current industry and government safety standards applicable to golf car operation and maintenance. These recommended procedures specify conditions, methods, and accepted practices that aid in the safe maintenance of golf cars. They are listed here for the reference and safety of all workers during maintenance operations.

Carefully read and understand these instructions and the specific maintenance procedures before attempting to do any repair work. When in doubt of any maintenance procedure, please contact your local CLARK dealer.

1. Golf cars can become hazardous if maintenance is neglected. Therefore, suitable maintenance facilities and trained personnel and procedures shall be provided.
2. Maintenance and inspection of all golf car vehicles shall be performed in conformance with the manufacturer's recommendations.
3. Follow a scheduled or planned maintenance, lubrication, and inspection system.
4. Only trained and authorized personnel are permitted to maintain, repair, adjust in accordance with the manufacturer's specifications.
5. Always wear safety glasses. Wear a safety (hard) hat in industrial plants and in special work areas where protection is necessary and required.
6. Properly ventilate work area, vent exhaust fumes, and keep shop clean and floors dry.
7. Avoid fire hazards and have fire protection equipment present in the work area. Do not use an open flame to check for leakage. Do not use open pans of fuel or flammable cleaning fluids for cleaning parts.
8. Before starting work on golf car:
 - Raise drive wheels free of floor and use jack stands or other positive golf car positioning devices. (See CLARK Service Manual for proper Jacking and Blocking procedures.)
 - Remove all jewelry (watches, rings, bracelets, etc.).
 - Disconnect the battery ground cable (-) before working on the electrical system.

Planned Maintenance and Lubrication

9. Operation of the golf car to check performance must be conducted in an authorized, safe, clear area.
10. Before starting to operate the golf car:
 - Be seated in a safe operating position.
 - Make sure parking brake is applied.
 - Check functioning of, direction and speed controls, steering, brakes, warning devices (if equipped).
11. Before leaving the golf car:
 - Stop the vehicle.
 - Apply the parking brake.
 - Turn the key switch to the OFF position.
 - Put blocks at the wheels if the golf car must be left on an incline.
12. Brakes, steering mechanisms, control mechanisms, warning devices, lights, canopy (if installed) and frame members must be carefully and regularly inspected and maintained in a safe operating condition.
13. The vehicle manufacturer's capacity, operation, and maintenance instruction plates, tags, or decals must be maintained in legible condition.
14. Batteries, limit switches, protective devices, electrical conductors, and connections must be maintained in conformance with good practice. Special attention must be paid to the condition of electrical insulation.
15. To avoid injury to personnel or damage to the equipment, consult the manufacturer's procedures in replacing contacts on any battery connection.
16. Golf cars must be kept in a clean condition to minimize fire hazards and help in detection of loose or defective parts.
17. Modifications and additions that affect capacity and safe vehicle operation must not be done without the manufacturer's prior written approval. Capacity, operation, and maintenance instruction plates, tags, or decals must be changed accordingly.

Planned Maintenance and Lubrication

18. Care must be taken to assure that all replacement parts, including tires, are interchangeable with the original parts and of a quality at least equal to that provided in the original equipment. Parts, including tires, are to be installed per the manufacturer's procedures. Always use genuine CLARK or CLARK-approved parts.

WARNING

When removing tires follow industry safety practices. Most importantly, deflate pneumatic tires completely prior to removal.

19. Use special care when removing heavy components. Be sure that lifting and handling equipment is of the correct capacity and in good condition.

IMPORTANT

Your new CLARK golf car has been built to meet all applicable mandatory requirements of ANSI/ILTV Z130.1 (Safety Standard for Personnel and Golf Cars).

Planned Maintenance and Lubrication

Time intervals between maintenances are largely determined by operating conditions. For example, operation in sandy, dusty locations requires shorter maintenance intervals than operation in clean areas. The indicated intervals are intended for normal operation.

The operating condition classifications are:

Normal Operation

Operating in open air on clean paved surfaces.

Severe Operation

Prolonged operating hours or constant usage.

Extreme Operation

- In sandy or dusty locations.
- High-temperature locations.
- Sudden temperature changes, such as constant trips from buildings into the open air.

If the golf car is used in severe or extreme operating conditions, you must shorten the maintenance intervals accordingly.

NOTICE

Since the operating environment of golf car varies widely, the above descriptions are highly generalized and should be applied as actual conditions dictate.

Planned Maintenance and Lubrication

PM Report Form

Make and keep records of your PM inspections. Use these records to help establish the correct PM intervals for the golf car application and to indicate maintenance required to prevent major problems from occurring during operation.

As an aid in performing and documenting your PM inspections, CLARK has prepared a ***Golf Car Planned Maintenance Report Form***. Copies of this form may be obtained from your authorized CLARK dealer. We recommend that you use this form as a checklist and record of your inspection and golf car condition.

The maintenance procedures outlined in this section are intended to be used in conjunction with the PM Report Form. They are arranged in a logical and efficient sequence.

You make a check mark or entry on the PM Report Form when the PM is performed. A special coding system for indicating the importance of needed repairs and/or adjustments appears on the form.

When you have finished the PM inspections, be sure to give a copy of the report to the designated authority or person responsible for golf car maintenance.

Do not make repairs or adjustments unless authorized to do so.

CAUTION

For safety, it is good practice to:

- **Remove all jewelry (watch, rings, bracelets, etc.) before working on the truck.**
- **Disconnect the battery ground cable (-) from the battery before working on electrical components.**
- **Always wear safety glasses. Wear a safety (hard) hat in industrial plants and in special work areas where protection is necessary and required.**

Planned Maintenance and Lubrication

BURDEN CARRIER PLANNED MAINTENANCE REPORT

CUSTOMER _____

MODEL & SERIAL NO. _____

AUTHORIZED SIGNATURE _____

INSPECTOR _____

SPECIAL INSTRUCTIONS _____

CODE	✓ OK
OK	x Adjust (Not PM)
Delayed	r Repair or Replace
Urgent	s Reqs Shop Repair
Date _____	Hour Meter _____
Date Last PM _____	HRS. Last PM _____
CUST. PO. NO. _____	

Comments:

A. TEST DRIVE MACHINE a. Drive Train Noise b. Steering Operation c. Service Brake Operation d. Speed Control e. Regen Braking f. Pedal Pads and Linkage g. Parking Brake Operation h. Pedestrian Warning Devices (if equipped)	19 ELECTRICAL TESTS a. Ground Tests b. Cable & Terminal Condition c. Wire Harness Condition d. Speed Pot Test e. Contactor Assembly f. Contactor Tip Condition	26 STEER AXLE a. Security of Mounting b. Axle Stop Adjustment c. Drag Link Adjustment d. King Pins e. Check Wheel Bearings
01 CLEANING & LUBRICATION a. Air Clean Truck b. Air Clean Electrical Controls c. Air Clean Motor d. Lubricate Truck	20 DRIVE AXLE CONDITION *a. Differential Fluid Level b. Clean Air Vent c. Security of Mounting	26 STEERING SYSTEM a. Security of Mounting
12 BATTERY AND CABLES a. Cable Condition b. Electrolyte Level c. Battery Load Test d. Battery Retention e. Specific Gravity	23 WHEELS AND TIRES a. Tighten Mounting Bolts b. Tire Condition c. Drive d. Steer e. Tire Pressure	38 SHEET METAL a. Decals - Missing / Conditions b. Data Plate Condition c. Seat Mounting & Operation d. Floor Mats
16 MOTORS a. Drive Motor Condition	23 BRAKES a. Service Brake Wear / Adjustment b. Park Brake Wear / Adjustment c. Brake Cable Condition d. Brake Linkage Check and Lubricate	* See Maintenance Interval in Service Manual

Test Drive Golf car

Walk around the vehicle and take note of any obvious damage or maintenance problems. If no visible damage, test drive the vehicle.

Make note of the following:

- Drive train noise
- Steering operation
- Brake operation
- Parking brake operation
- Speed control
- Regenerative braking
- Pedal pads and linkage
- Warning devices (if installed)

Cleaning and Lubrication

- Air clean golf car
- Air clean motor
- Lubricate golf car (see lubrication chart)
- Lubricate golf car components

Check Battery and Cables

- Check cable condition
- Check battery retention
- Check electrolyte level
- Test specific gravity
- Perform battery load test

Planned Maintenance and Lubrication

Motor

- Drive motor and brush condition

Electrical Tests

- Check battery ground
- Check cable and terminal condition
- Check wire harness condition
- Perform speed pot test
- Check contactor assembly

Drive Axle Condition

- Check differential fluid level
- Clean air vent
- Check mounting bolts

Wheels and Tires

- Tighten mounting bolts
- Check tire condition
- Check drive and steer wheels
- Check tire pressure

Brakes

- Service brake wear / adjustment
- Check park brake adjustment
- Check brake cable condition
- Brake linkage / check and lubricate

Steer Axle

- Check mounting bolts
- Check king pins
- Check wheel bearings
- Drag link / check and adjust

Steering System

- Check mounting bolts

Golf Car Body

- Check decals - missing/condition
- Check data plate
- Check floor mats
- Check seat mounting

Planned Maintenance and Lubrication

Visual Inspection

First, perform a visual inspection of the golf car and its components. Walk around the vehicle and take note of any obvious damage or maintenance problems.

Check to be sure all capacity, safety, and warning plates are attached and legible.

NOTICE

NAME PLATES AND DECALS: Do not operate a golf car with damaged or lost decals and nameplates. Replace them immediately. They contain important safety information.

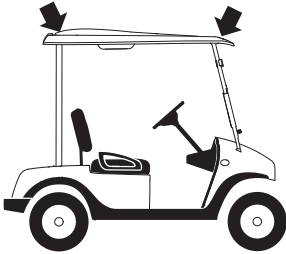

Canopy (if installed)

Be sure that the driver's canopy and any safety devices are in place, undamaged, and attached securely.

Check the canopy for damage. Be sure that it is properly positioned and all mounting fasteners are in place and tight.

IMPORTANT

Optional canopy does not protect against falling objects and is not designed to provide rollover protection.

Wheels and Tires

Check the condition of the drive and steer wheels and tires. Remove objects that are embedded in the tread. Inspect the tires for excessive wear.

Check all wheel lug nuts or bolts to be sure none are loose or missing. Replace missing bolts or lug nuts. Torque loose or replaced items to specifications.

WARNING

Check tire pressure from a position facing the tread of the tire, not from the side. Use a long-handled gauge to keep your body away from the side. If tires are low, do not operate and do not add air. Check with a mechanic. The tire may require removal and repair. Incorrect (low) tire pressure can reduce the stability of your vehicle. Do not operate with low tire pressure.

Planned Maintenance and Lubrication

Horn

Press the horn button to check horn function. If the horn or any other part does not operate, report the failure and have it repaired before the truck is put into operation.

Service Brake

With the key switch in the “ON”, push the service brake pedal fully down and hold. The brakes should apply before the pedal reaches the floorplate. If the pedal continues to creep downward, report the failure immediately. Do not operate the truck until the brakes are repaired.

Parking Brake

Check the function of the parking brake. Release, then reapply. To check parking brake holding capability, park the golf car on a grade and apply the parking brake. The parking brake should hold a golf car on a 15% grade.



CAUTION

Do not operate golf car if the service or parking brakes are not operating properly.

Planned Maintenance and Lubrication

Steering System

NOTICE

The steering system, steer axle, and steering linkage on your golf car should be inspected periodically for abnormal looseness and damage, leaking seals, etc. Also, be alert for any changes in steering action. Hard steering, excessive freeplay (looseness), or unusual sound when turning or maneuvering indicates a need for inspection or servicing.

Check the steering system by moving the steering handwheel in a full right turn and then in a full left turn. Return the handwheel to the straight-ahead position. The steering system components should operate smoothly when the handwheel is turned. **Never operate a golf car that has a steering system fault.**

Direction Control, Braking

Be sure that the travel area is clear in front of the golf car.

Release the parking brake.

1. Place the directional control switch to FORWARD
2. Remove your right foot from the brake pedal and put it on the accelerator pedal. Push down until the vehicle moves slowly forward. Remove your foot from the accelerator pedal and push down on the brake pedal to stop the truck. The brakes should apply smoothly and equally. Be sure the travel area is clear behind the carrier.
3. Put the directional control switch in the REVERSE travel position. Release the brake and push down on the accelerator pedal until the golf car moves slowly in the reverse direction. Remove your foot from the accelerator pedal and push down on the brake pedal to stop the golf car. The brakes should apply smoothly and equally.

Report any problems.

When you have completed the operational tests, park and leave the golf car according to standard shut down procedure as described in this manual. Be sure to make a record of all maintenance and operating problems you find.

Planned Maintenance and Lubrication

Battery/Charger Compartment

The battery compartment is typically located under the seat.

- To gain access raise the seat as shown in the illustration.

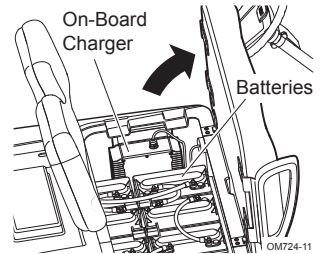

Battery Inspection

Inspect the batteries for damage, cracks, leaking condition, etc. If the terminals are corroded, clean and protect them with CLARK Battery Saver (available from your CLARK dealer). If your batteries have removable cell caps, check to be sure the cells are all filled. Refill them with distilled water.

IMPORTANT

NEVER add distilled water to a low battery. This could shorten the life of the battery. Only add distilled water after a battery is fully charged.

WARNING

EXPLOSIVE GASES: Do not smoke or have open flames or sparks near batteries. An explosion can cause injury or death.

On-Board Charger

The on-board charger is located under the seat on the driver side of the vehicle. The charger is directly connected to the batteries, only requiring it be plugged into a dedicated 15 amp AC outlet to be operational.

When charging cycle is complete, replace cord around charger handle in area provided.

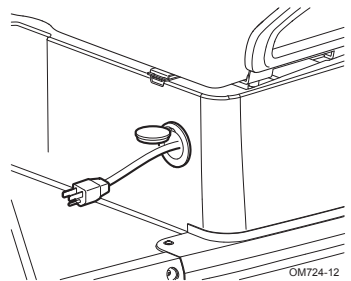

Planned Maintenance and Lubrication

Designated Charging Area

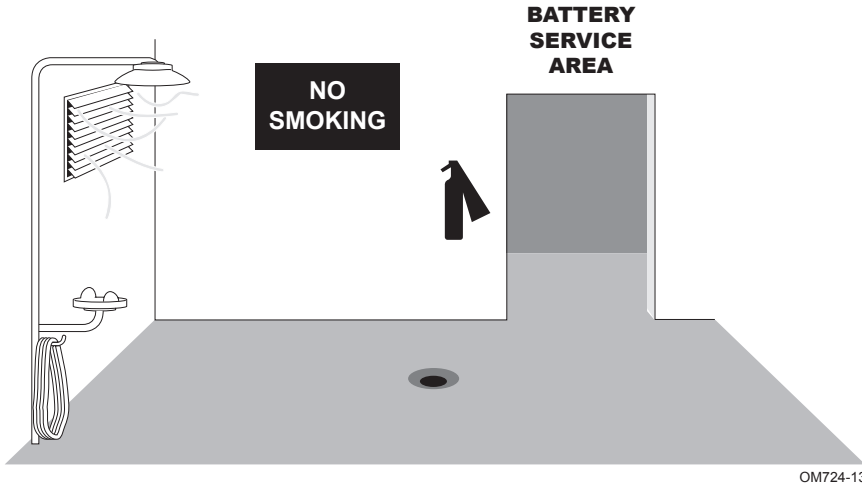

Battery charging must be done in areas designated for that purpose. These areas must be kept free of all non-essential combustible materials.

Facilities must be provided for:

- Flushing spilled electrolyte.
- Fire protection.
- Protecting charging apparatus from damage by vehicle.
- Adequate ventilation for dispersal of fumes from gassing batteries.

When handling acid concentrates greater than 50% acid (above 1.400 specific gravity), an eye wash fountain must be provided.

Batteries

CLARK golf cars are equipped with six or eight batteries (depending on vehicle configuration) mounted on the frame usually located under the drivers seat.

It is not necessary to remove the seat from the vehicle to charge the batteries.

Planned Maintenance and Lubrication

A charging plug is provided for ease of connecting the proper charger to the golf car batteries.

WARNING

The power (AC) cord is equipped with a grounded plug, do not attempt to remove, cut or bend the ground post of the grounded plug.

To reduce the possibility of electrical shock or possible electrocution, be sure that the on board charger plug is not damaged and is inserted into a proper grounded receptacle.

1. Change (remove) or service storage batteries only in an area designated for this purpose.
2. Be sure this area has provisions to flush and neutralize spillage, to ventilate fumes from gassing batteries, and for fire protection.
3. Keep all tools and other metallic objects away from terminals.

WARNING

BATTERY SERVICE must be done by trained and authorized personnel. Battery acid can cause severe burns and injury.

Battery Charging

1. Persons maintaining storage batteries must wear protective clothing such as face shield, long sleeves, and gloves.
2. Hydrogen emissions from charging batteries are explosive. No smoking is allowed in the charging area. Do not check the electrolyte level with an open flame. Do not allow open flame, sparks, or electric arcs in battery charging area.

WARNING

SULFURIC ACID: The battery contains corrosive acid that can cause injury. If acid contacts your eyes or skin, flush immediately with water and get medical assistance.

WARNING

EXPLOSIVE GASES: Do not smoke or have open flames or sparks on battery charging areas or near batteries. An explosion can cause injury or death.

Planned Maintenance and Lubrication

3. When charging batteries, the vent caps must be kept in place to avoid electrolyte spray. Care must be taken to assure that vent caps are open (clean) and functioning.

IMPORTANT

If batteries discharge rapidly during normal operation or do not charge to the correct specifications, contact a qualified battery service technician to check the battery for you. Do not add electrolyte or attempt to service the battery.

Battery Removal from Golf Car

1. Check the designated service and charging area for fire protection, and be sure all sources of ignition are cleared from the area. **Do not smoke!** Be sure all adequate equipment is in the area, in good repair, and working properly. If batteries are to be serviced, be sure there are provisions to flush and neutralize spillage and to disperse (ventilate) fumes from gassing batteries on charge. And, be sure there are provisions for handling electrolyte.
2. Before attempting to remove or charge a storage battery, the truck should be positioned in the designated battery service area and the parking brake applied so the truck cannot move.
3. Remove seat if necessary.
4. Remove the battery and move it to a safe storage location. Store batteries either on an approved battery rack or on a wooden pallet.

Battery Cleaning and Repair

Never wash the battery when it is in the truck. The easiest and most satisfactory method of cleaning a battery is to wash it occasionally with a low-pressure cold-water spray. The top can also be washed off with a solution of baking soda and water (add a box of baking soda to a pail of water and stir until dissolved) and rinsed with clean water. It is good practice to have this solution in a battery room at all times.

Planned Maintenance and Lubrication

IMPORTANT

During cleaning, the battery vent caps must be tightly in place.

Refer to the battery manufacturer or supplier for their recommended battery maintenance and care procedures.

BATTERY SAVER and CLEANER, may be used to clean and protect the truck battery. (Available from you local Clark Dealer)

New Truck Batteries: Apply a light coat of BATTERY SAVER and CLEANER to entire surface of battery. Allow to set for approximately 30 seconds, then wipe thoroughly with a wiping cloth or rag. Chemical action will dissolve rust and corrosion. After cleaning, apply a second coating for protection. This will prevent the start and growth of corrosion on battery terminals and cable connections.

WARNING

**Disconnect battery before handling electrical components.
Polarity must be correct to prevent damage.**

Recycling Lead-Acid Batteries

WARNING

Lead-acid batteries contain lead (Pb), other metals, acids and other compounds. If improperly handled, they can contaminate both water and soil, causing environmental damage and personal injury.

Lead-acid batteries are identified by the symbol shown and should be properly recycled. They cannot be disposed as common waste. Lead-acid batteries must be collected separately.



Responsibility for environmental protection must be shared, not only by the manufacturers of the batteries, but by people who use the batteries as well. Contact your nearest CLARK dealer or battery distributor for information on how to properly recycle your batteries.

Planned Maintenance and Lubrication

Lubrication

Golf car Chassis Inspection and Lubrication

Lubrication and inspection of chassis components, including steer wheels, steer axle linkage and wheel bearings are easier if the golf car is raised and blocked up under the frame.

WARNING

Inspect the steering system seals, and fasteners for damage, leaks, and looseness. Lubricate the steer axle linkage rod ends and linkage pivot points. Be sure to clean the grease fittings before lubricating, and remove the excess grease from all points after lubricating. Lubricate miscellaneous linkage as needed.

Planned Maintenance and Lubrication

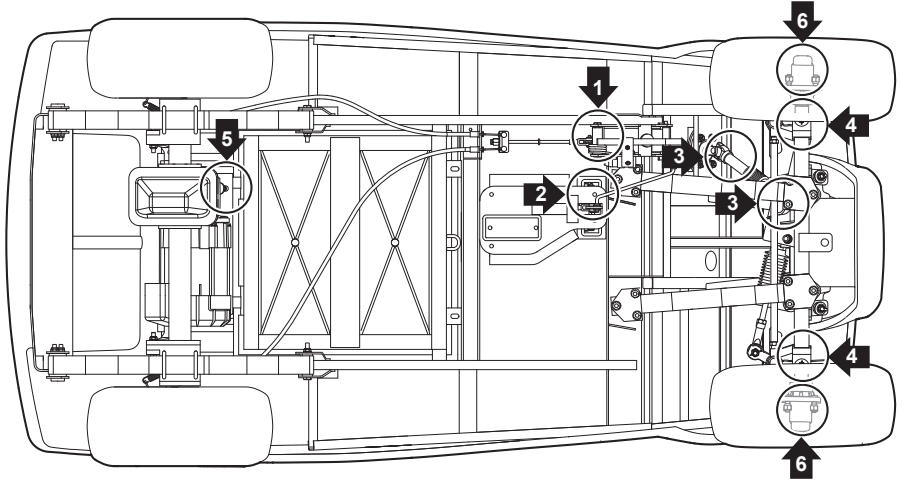

IMPORTANT

Inspection and servicing should be carried out by a trained and authorized mechanic.

Schedule	Inspection	Position	Recommended Lubricating Oil
Quarterly Inspection	Shaft, Brake Pedal	1	General Purpose Lithium Base Grease
	Shaft, Accelerator Pedal	2	High Quality Spray Lube
	Steering Gearbox and column	3	General Purpose Lithium Base Grease
	Spindle, King Pin	4	General Purpose Lithium Base Grease
Annual Inspection (per 200 rounds or 100 work hours)	Check Drive Axle, Fill Oil to Seal Position	5	Lucas 85-140
	Check Front Wheel Bearings	6	General Purpose Lithium Base Grease

Planned Maintenance and Lubrication

Specifications

Contents

Contents	6-1
Model Designation (GC2)	6-2
Model Designation (GO240)	6-2
Model Designation (TR240)	6-3
Warranty	6-4

Specifications

Clark products and specifications are subject to improvements and changes without notice or obligation.

Model Designation (Golf Car)

	Series Model	GC2	GO240 GOAT 2/ GOAT 4
Drive System		Electric	Electric
Motor		DC	AC
HP		3.5HP	6.0HP
Voltage		48V	48V
Controller		260Amp	450Amp
Batteries (optional)		6x8V / 8x6V	6x8V / 8x6V
Charger		12A Hi Freq	12A Hi Freq
Range		10-30mi	10-30mi
Speed		14.9 mph	12.0 mph
Grades		14°	14°
Steering		Rack and Pinion	Rack and Pinion
Suspension	(front and rear)	Leaf Springs Gas Shocks	Leaf Springs Gas Shocks
Brakes		Rear Drum	Ausco Rear Disc
Car Length		105"	108/132"
Car Width		47.25"	51"
Car Height		79" with top	86.25"
Turning Radius		9'8"	14'
Vehicle Capacity		800lbs	800/1200lbs
Windshield		Optional	Optional
Canopy		Optional	Optional
Wheels		8" Steel	12" Steel
Tires		18x8.50-8	23 x10.50 - 12
Lights / Horn		Head / Tail Lights Turn Signal, Horn	Head / Tail Lights Turn Signal, Horn
DC-DC Converter		48 Volt - 12 Volt	48 Volt - 12 Volt
Warranty		One Year	One Year

Specifications

Clark products and specifications are subject to improvements and changes without notice or obligation.

Model Designation (Transport)

	Series Model	TR240 TR 2+2	TR240 TR 4+2
Drive System		Electric	Electric
Motor		DC	DC
HP		3.5HP	3.5HP
Voltage		48V	48V
Controller		260Amp	260Amp
Batteries (optional)		6x8V / 8x6V	6x8V / 8x6V
Charger		12A Hi Freq	12A Hi Freq
Range		10-30mi	10-30mi
Speed		12.0 mph	12.0 mph
Grades		14°	14°
Steering		Rack and Pinion	Rack and Pinion
Suspension	(front and rear)	Leaf Springs Gas Shocks	Leaf Springs Gas Shocks
Brakes		Rear Drum	Ausco Rear Disc
Car Length		98"	128.5"
Car Width		47.25"	47.25"
Car Height		79" with top	79" with top
Turning Radius		9'8"	14'
Vehicle Capacity		800lbs	1200lbs
Windshield		Optional	Optional
Canopy		Optional	Optional
Wheels		8" Steel	10" Steel
Tires		18x8.50-8	205/65-10
Lights / Horn		Head / Tail Lights Turn Signal, Horn	Head / Tail Lights Turn Signal, Horn
DC-DC Converter		48 Volt - 12 Volt	48 Volt - 12 Volt
Warranty		One Year	One Year

WARRANTY

ONE-YEAR PROTECTION

When you buy or lease the new CLARK Electric Car listed below from CLARK or an authorized CLARK dealer, CLARK warrants that its dealers will correct defects in material or workmanship under normal use and service as follows:

For the first twelve months after the product has been delivered to you, the CLARK dealer will, without charge, provide genuine CLARK parts and labor to replace or repair any covered part furnished by CLARK and found to be defective in material or workmanship.

CONDITIONS, EXCLUSIONS AND LIMITATIONS: During the above warranty periods, CLARK requires that the product receives normal use and recommended regular maintenance, that you give CLARK or a CLARK dealer reasonable notice of the defect, and that you permit the dealer to return defective parts to CLARK.

Replacement parts provided under this warranty are covered herein for the remainder of the warranty period applicable to the truck in which they are installed.

This warranty plan does not apply to the expense of the service call (travel time) nor the cartage of the unit to or from the dealership.

Naturally, this warranty does not apply to damage arising from accident, misuse or neglect, use of non-CLARK parts, or from alterations not authorized by CLARK; nor does it cover replacement of fuses, decals, lubricants, routine wear items such as; charger plug receptacle, brake shoes and pads, tires, brushes, bushings, cosmetic deterioration, upholstery and items which deteriorate, fade, or fail due to exposure or ordinary wear and tear. Also not covered are adjustments, including initial field set-up. Adjustments are considered normal maintenance procedures. The costs of rental units are also not covered.

CLARK may make design changes in the interest of improving the efficiency of its products, but shall not incur any obligation to incorporate such improvements in any products that have been shipped or are in service.

Unless CLARK otherwise agrees in writing, this warranty is in lieu of all other warranties (except the warranty of title) and states CLARK's entire obligation with respect to defects in new product made or sold by CLARK. THERE ARE NO IMPLIED WARRANTIES OF MERCHANTABILITY AND FITNESS FOR A PARTICULAR PURPOSE. IN NO EVENT SHALL CLARK BE LIABLE FOR INCIDENTAL, SPECIAL OR CONSEQUENTIAL DAMAGES

As used in this warranty, "CLARK" means CLARK Material Handling Company for products sold or leased in North America.

Serial Numbers

Truck: _____

Control Panel: _____

Drive Motor: _____

